

nuaire BPS Size 12 Revit Model Features

These models use type catalogues so all variants of the size 12 BPS AHU range that use the same heating/cooling coil combination can be inserted using the same .rfa file (see Read Me file attached for further info).

The file name relates directly to that of the item code of the unit i.e. **B12T/LR/ES-L** and the variants included are as follows:

| Code | Type of Coil | | | | | | | |
|--------|--------------|------|------|---------------|------|---------------------------------|---------------------------------|-----------|
| | Heating | | | Cooling | | | | Heat Pump |
| | Electric | LPHW | None | Chilled Water | None | Reverse Cycle DX with Condenser | Reverse Cycle DX (No Condenser) | |
| B12-EC | ■ | | | ■ | | | | |
| B12-EN | ■ | | | | ■ | | | |
| B12-ER | ■ | | | | | ■ | | |
| B12-EX | ■ | | | | | | ■ | |
| B12-HP | | | | | | | | ■ |
| B12-LC | | ■ | | ■ | | | | |
| B12-LN | | ■ | | | ■ | | | |
| B12-LR | | ■ | | | | ■ | | |
| B12-LX | | ■ | | | | | ■ | |
| B12-NC | | | ■ | ■ | | | | |
| B12-NN | | | ■ | | ■ | | | |
| B12-NX | | | ■ | | | ■ | | |
| B12-NR | | | ■ | | | | ■ | |

The B12-** models included have the following options in the Model Properties Category in the Properties Window

| Model Properties | |
|-------------------------------|--------------------------|
| Show Access Clearance | <input type="checkbox"/> |
| Show Atmosphere Side Silencer | <input type="checkbox"/> |
| Show Room Side Silencer | <input type="checkbox"/> |

1. 'Show Access Clearance allows you to show or hide the access clearance transparent area of the model. Please note that the access clearance area will still affect the collision detection even if turned off).

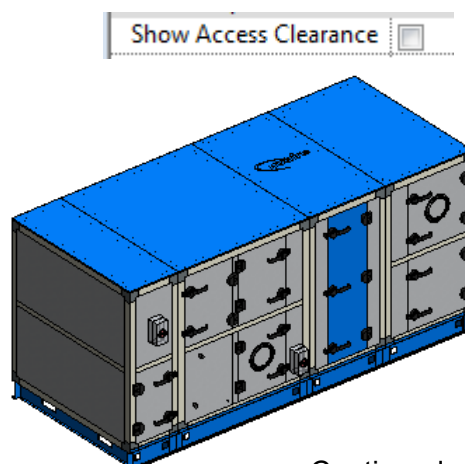
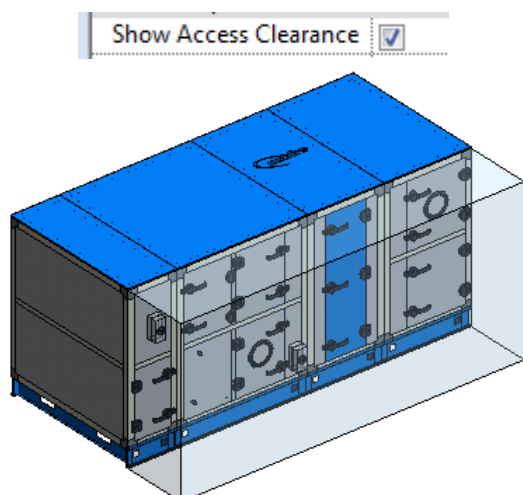

Continued on next page...

2. 'Show Room Side Silencer' and 'Show Atmosphere Side Silencer' allow you to show or hide the corresponding matched attenuator for that end of the unit.

| | |
|-------------------------------|--------------------------|
| Show Atmosphere Side Silencer | <input type="checkbox"/> |
| Show Room Side Silencer | <input type="checkbox"/> |

| | |
|-------------------------------|--------------------------|
| Show Room Side Silencer | <input type="checkbox"/> |
| Show Atmosphere Side Silencer | <input type="checkbox"/> |

| | |
|-------------------------------|-------------------------------------|
| Show Room Side Silencer | <input checked="" type="checkbox"/> |
| Show Atmosphere Side Silencer | <input type="checkbox"/> |

| | |
|-------------------------------|-------------------------------------|
| Show Room Side Silencer | <input checked="" type="checkbox"/> |
| Show Atmosphere Side Silencer | <input checked="" type="checkbox"/> |

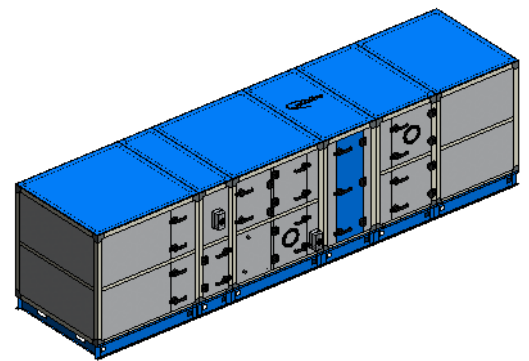
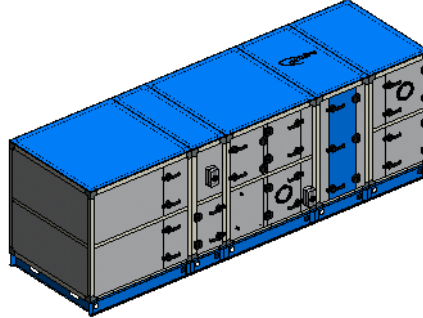
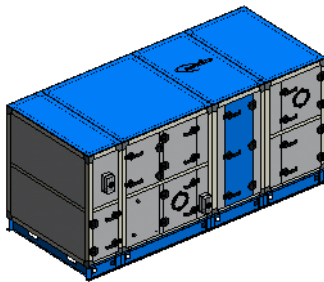

3. When applicable (ER, LR or NR models only), the zip file will also contain a separate model of the matched condenser (outdoor unit) we offer with this unit (**BPS-CU-MIT32-20**). (1No. required).

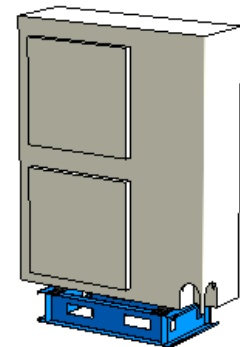

4. If the model is inserted into the project without using the correct procedure then you will be alerted via a red box and 'ERROR' wording around the model. The model code will also show this same message in the schedules. Please then refer to the additional 'Please read Me File' packaged with this family for the correct insertion procedure.

