

XBC+ Size 51

Revit Model Features

These models use type catalogues so all variants of the XBC+ Size 51 range, when utilising the same heating coil option, can be inserted using the same .rfa file.
See the Read Me file attached for further info.

Nuaire_lfcFanType_Xbc51-L.rfa contains the **L**PHW heater variants e.g. XBC51HA-**L**HN-LS1S.
Nuaire_lfcFanType_Xbc51-E.rfa contains the **E**lectric heater variants e.g. XBC51HA-**E**HN-RS1W.
Nuaire_lfcFanType_Xbc51-N.rfa contains the **N**o heater variants e.g. XBC51HA-**N**NN-RB1S.

The XBC51 models included each have the following options in the 'Model Properties' category in the Properties window:

1. '**Discharge Silencer**' etc. are drop down boxes that allow you to choose which matched silencers to use. The choice of silencer lengths are: MS10 (1050mm), MS12 (1450mm) & MS16 (1600mm).

The HE/HS part of the code refers to which connection they are designed for:

- HE** - This silencer is suitable for the smaller **E**xtract and intake connections on the sides.
- HS** - This silencer is suitable for the larger **S**upply and discharge connections in the centre.

Choosing an option that does NOT match the connection will not work and the silencer will not be shown on the unit or scheduled.

Model Properties	
Discharge Silencer<Duct Accessories>	XBC Silencer : none
Extract Connection Option 2	<input type="checkbox"/>
Extract Silencer<Duct Accessories>	XBC Silencer : none
Intake Connection Option 2	<input type="checkbox"/>
Intake Silencer<Duct Accessories>	XBC Silencer : none
Show Access Clearance	<input checked="" type="checkbox"/>
Supply Silencer<Duct Accessories>	XBC Silencer : none

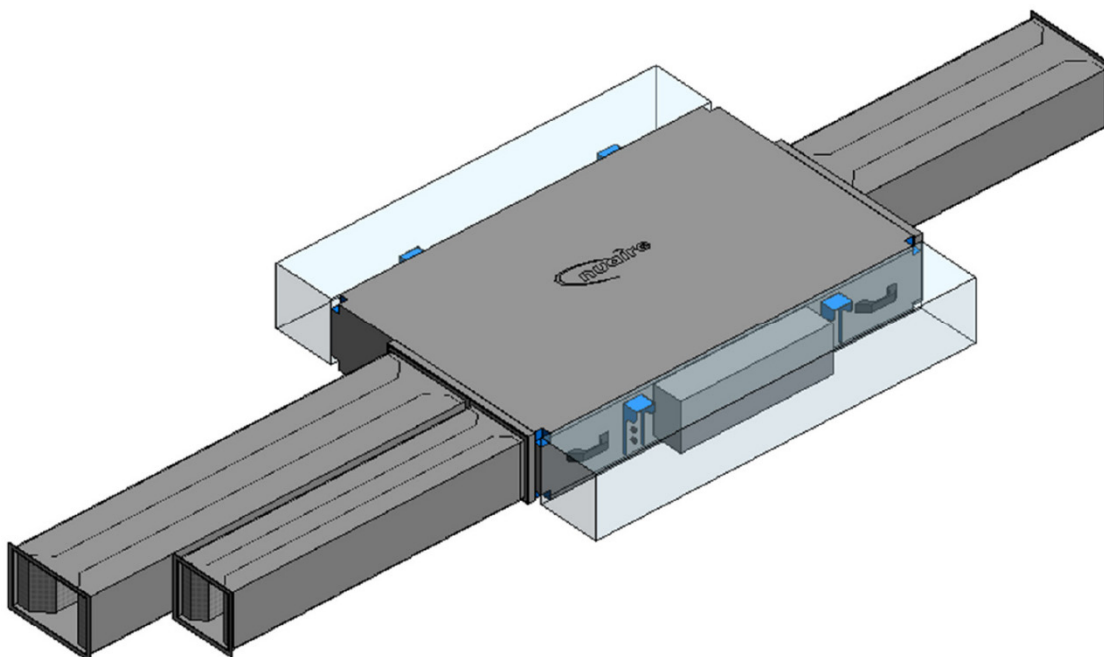

2. The XBC51 units come with a choice of left or right-handed duct connections that are to be chosen on site by the ducting contractor.

'Intake Connection Option 2' and 'Extract Connection Option 2' will switch the connection on the Revit model to the other side as required.

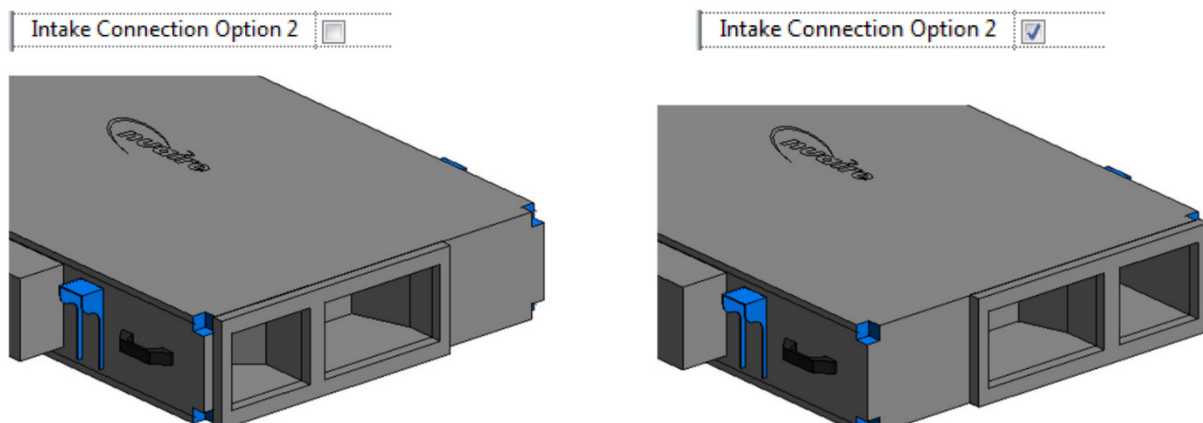

3. 'Show Access Clearance' allows you to show or hide the access clearance transparent area of the model.

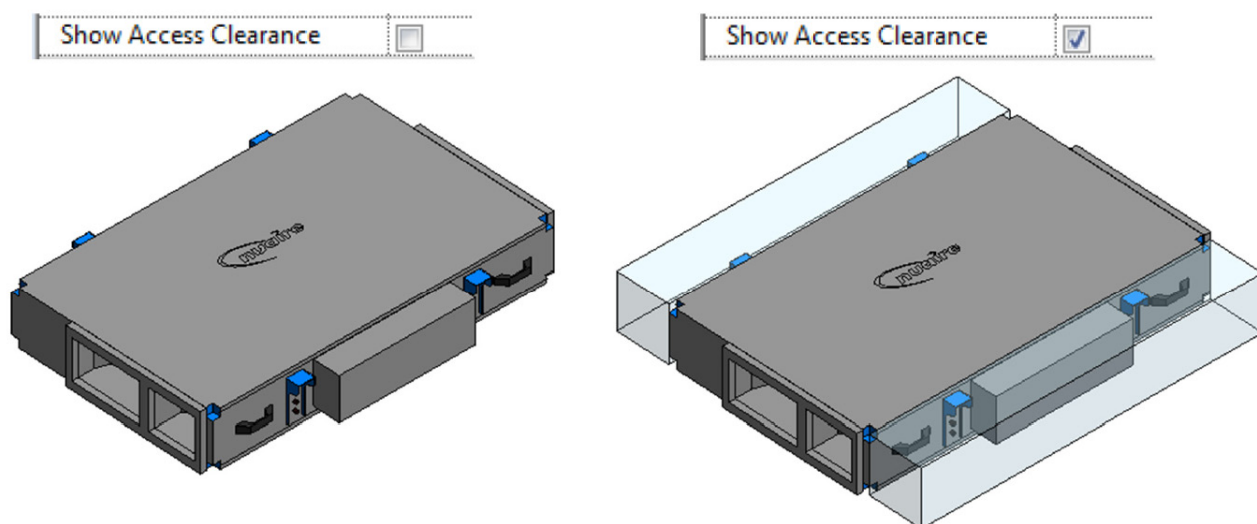

4. If the model is inserted into the project without using the correct procedure, then you will be alerted via a red box and 'ERROR' wording around the model. The model code will also show this same message in the schedules. Please then refer to the additional 'Please Read Me' packaged with this family for the correct insertion procedure.

