



ES-UCF, ES-UCFH, and ES-UCFHC

Extra Low Voltage User Controls

CE The EMC Directive 2014/30/EU
The Low Voltage directive 2014/35/EU



ES-User Control

Designed to be compatible with the Ecosmart system, this user control is supplied with a pre-plugged, 10 metre length of communications cable. Note: longer lengths are available if required.

The units operate with Safe Extra Low Voltage (SELV) with power supplied from the fan unit via the communications cable.

Parts check list:

- 1 off ES-User Control
- 1 off 10 metre length of plugged SELV cable

Model range:

ES-UCF Ventilation only. Used to switch the fan on/off and adjust the fan speed.

ES-UCFH Ventilation and Heating. Used to switch the fan and heater (if fitted) on/off and to adjust the fan speed.

ES-UCFHC Ventilation, Heating and Cooling. Used to switch the fan, heater and chiller (if fitted) on/off and to adjust the fan speed.

Handling

Always handle the controls carefully to avoid damage and distortion.

Installation

The installation must be carried out by competent personnel in accordance with the appropriate authority and conforming to all statutory and governing regulations i.e. IEE, CIBSE, CCHSE, HVCA etc.

The unit is suitable for indoor use only. Mount on a secure, vibration free vertical surface away from any direct source of heat and areas where it would be subjected to waterspray. The maximum permissible ambient temperature is 40°C.

Figure 1.

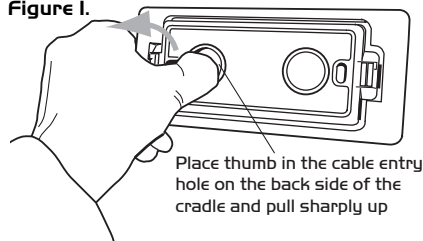

a) Removing the mounting cradle from the backing plate on the rear of the control. Insert your thumb in a cable entry hole and lift sharply. See figures 1 and 2. Offer the cradle to the selected mounting position, mark and fix.

Figure 2.

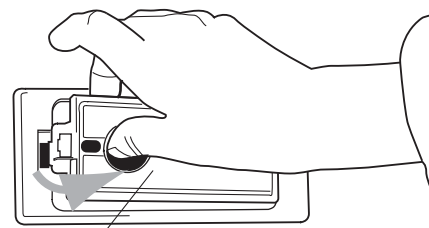

b) Draw approx. 75mm of data cable through the cradle and plug in to the rear socket of the control, paying particular attention to plug/socket colour code for correct orientation.

Figure 3.

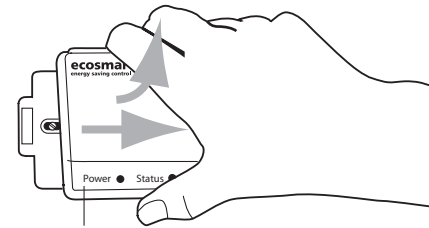

c) Clip the control into the cradle.

d) Removing the control module from the backing plate. Press firmly on either side of the control, strain sharply across to the right and lift the left hand side of the control module out. See figure 3.

The matched frequency inverter will have been pre programmed to suit the user control prior to delivery. Install the inverter in accordance with the instructions provided with it.

Connect the other end of the data cable to the inverter, remove the plug from the data cable and terminate, following the instructions provided with the inverter.

Unit dimensions & weights

Figure 4. ES User control with lid closed.

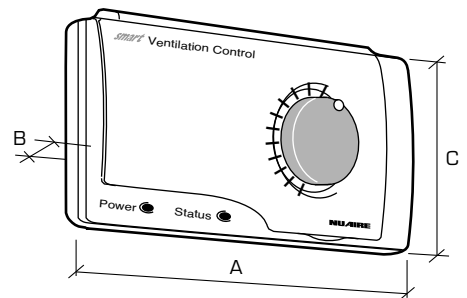

	A	B	C	Weight
Unit Dims..	163	40	75	0.25 Kg

Drill pattern & fixing detail

Figure 5.

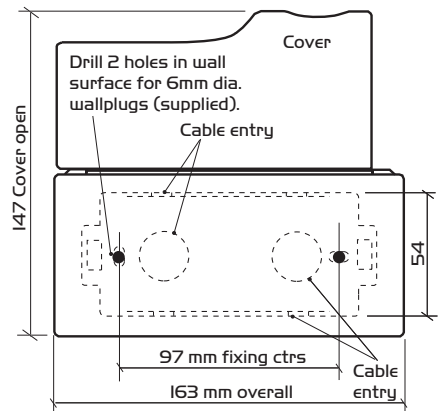

Data cable installation

A 4-core 10 metre length of SELV data cable is used to connect devices. Longer lengths are available if required. Do not run data cable in the same conduit as the mains cables and ensure there is a 50mm separation between the data cable and other cables. The maximum cable run between any two devices is 300m when it is installed in accordance with the instructions.

Operating the control

Press the relevant button once to select the function. Press again to cancel. Rotate the speed control dial knob to select the desired speed.

Green LED indicates function selected and working.

Red LED indicates a fault.

Flashing Green LED indicates fan operating on run on timer, stops when set time has expired.

Note: If the fan speed knob is set to AUTO the fan speed will be adjusted automatically by a sensor. If a sensor is not fitted the fan will be switched OFF unless trickle running has been selected on the fan.

Maintenance

The user control does not require any maintenance. However, for optimum performance, it is advisable to remove any accumulated dust with a low power vacuum cleaner.

Note: Installation and Maintenance of the equipment must be as directed in the instructions provided with the unit.

Warranty

The 5 year warranty starts from the day of delivery and includes parts and labour for the first year. The remaining 4 years covers replacement parts only.

This warranty is void if the equipment is modified without authorisation, is incorrectly applied, misused, disassembled, or not installed, commissioned and maintained in accordance with the details contained in this manual and general good practice.

The product warranty applies to the UK mainland and in accordance with Clause 14 of our Conditions of Sale. Customers purchasing from outside of the UK should contact Nuaire International Sales office for further details.

After Sales Enquiries

For technical assistance or further product information, including spare parts and replacement components, please contact the After Sales Department.

Telephone 02920 858 585