



# WHI & WM2 AV TRAY ASSEMBLY

For Mounting MRXBOX95-WHI & WM2  
Mechanical Ventilation with Heat Recovery Units

## Installation Guide

### I.O Parts List

ITEM	QTY	DESCRIPTION
1.	1	RH BRACKET, AV TRAY
2.	1	BRACE, AV TRAY
3.	1	LH BRACKET, AV TRAY
4.	4	AV mounts
5.	1	AV TRAY
6.	8	M6 x 20 Whizlock Bolt
7.	4	M10 x 25 Flanged Bolt
8.	2	M5 x 16 Flanged Bolt
9.	2	M5 Rivet Nut
10.	8	M6 Gripnut
11.	2	M5 Pozi pan hd screw
12.	2	30mm O/D x 5mm I/D washer
13.	6	Foam Pad

Fig 1: Key to components required to create the WHI & WM2 AV Tray to facilitate mounting the MRXBOX95-WHI & WM2 MVHR units.

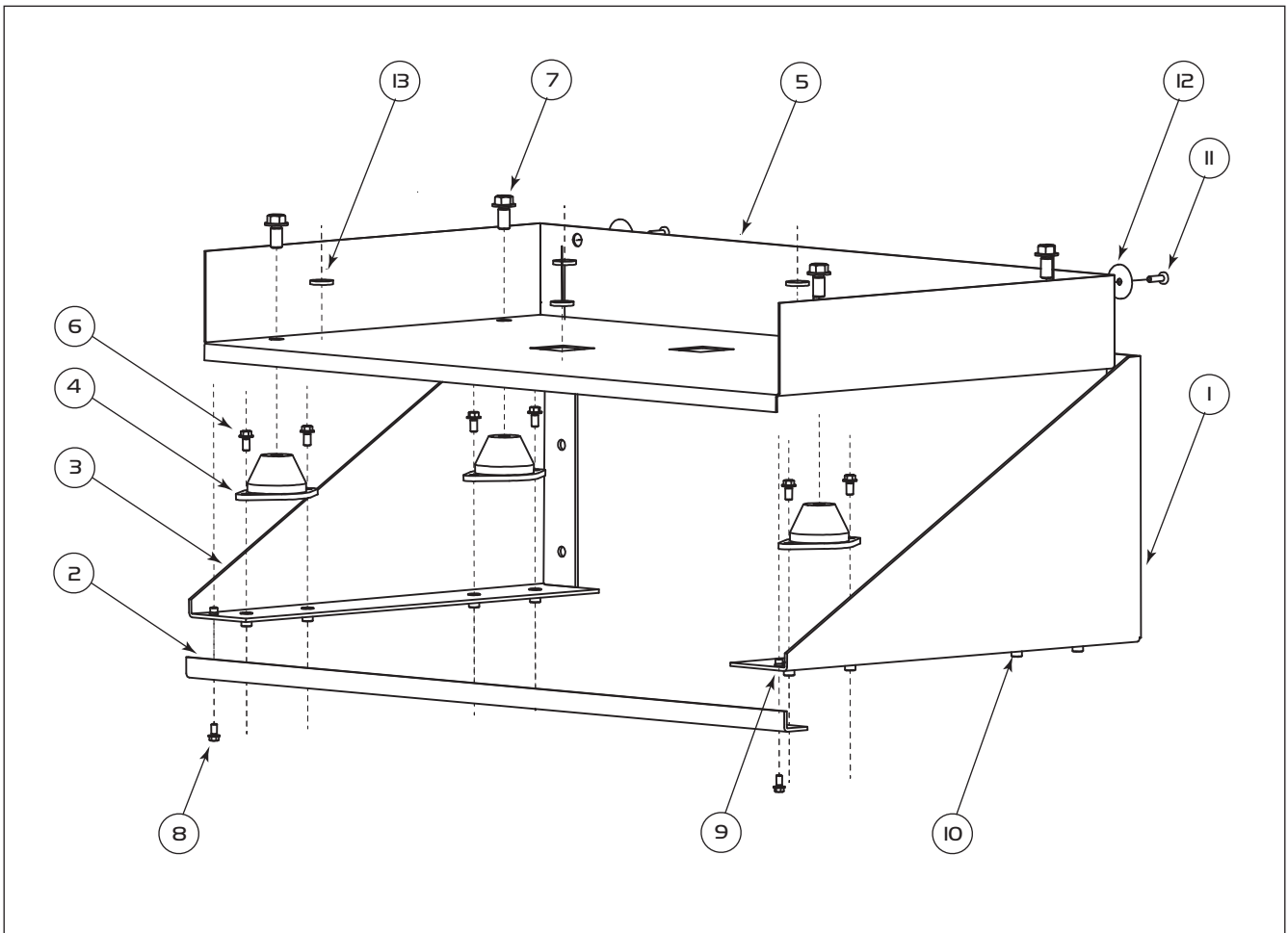

### 2.0 Installation Procedure

(Fig. 2.) Fit the 2 angle brackets to suitable mounting structure using appropriate fixings (not supplied); ensuring the brackets are fitted square and level. Now fix 2 AV mounts to each angle bracket using M6 x 20 bolts supplied (Fig. 3.)

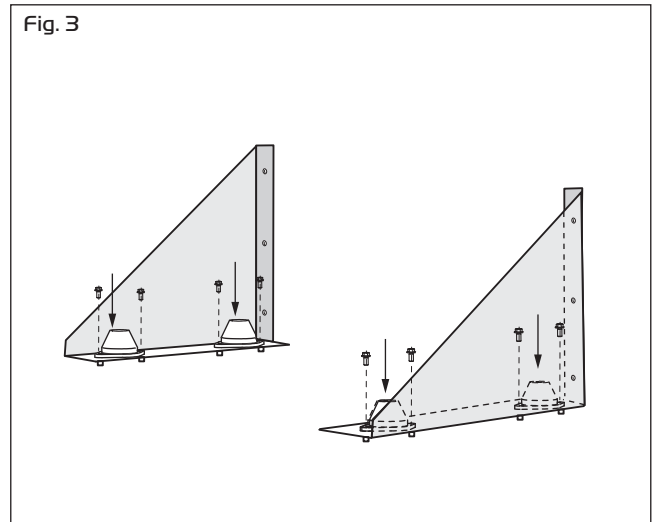
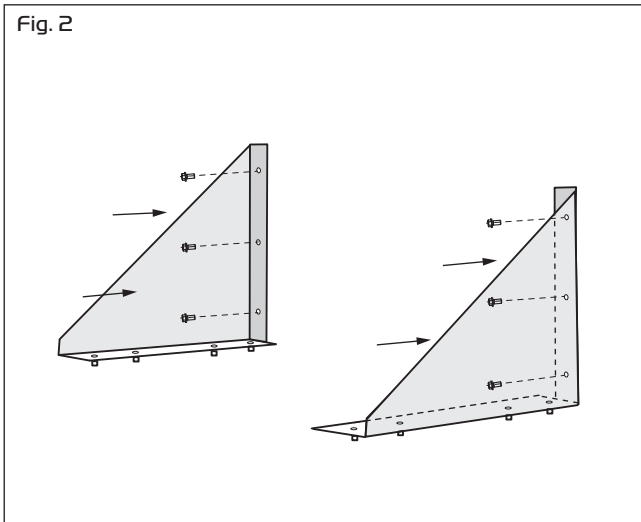

(Fig. 1.) Fit 6 self-adhesive Foam pads to base of unit. (Fig. 4.) Remove rubber feet from rear of unit and use these fixing positions to secure the tray with M5 x 20 posi head screws through large washer (supplied), take care when fitting the tray to ensure the power cable and condensate trap do not get damaged when locating them in the cut outs in the tray.

(Fig. 5.) Locate the assembled unit and tray onto the AV mounts and secure using M10 x 25 bolts supplied.

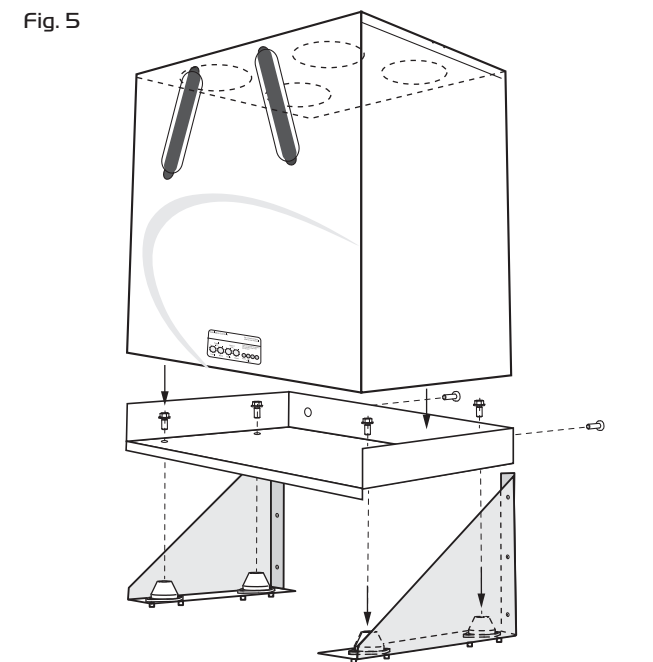
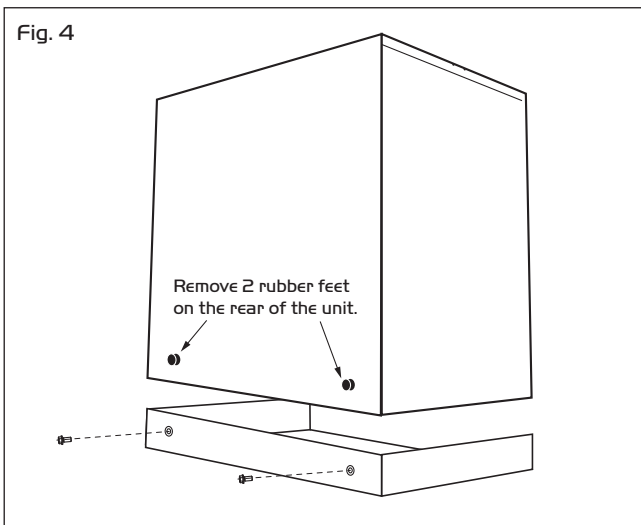

(Fig. 6.) Secure front cross brace to angle brackets with M5 x 16 bolts supplied.

### 6.0 Service Enquiries

Nuaire can assist you in all aspects of service. Our service department will be happy to provide any assistance required, initially by telephone and if necessary arrange for an engineer to call.

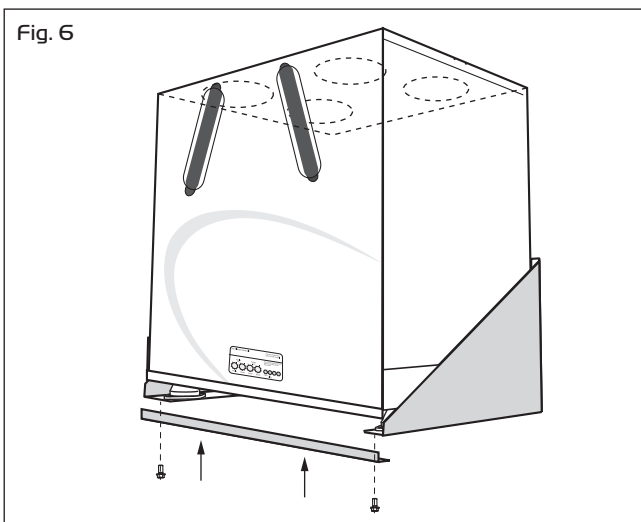

**Customer Services Department  
on 08705 002 555**

Technical or commercial considerations may, from time to time, make it necessary to alter the design, performance and dimensions of equipment and the right is reserved to make such changes without prior notice.